

DRAFT

Lehi City Existing and Proposed Buildout Pressure Irrigation System

Produced by Lehi City GIS
Jason DeWitt, GIS Coordinator
April 23, 2025

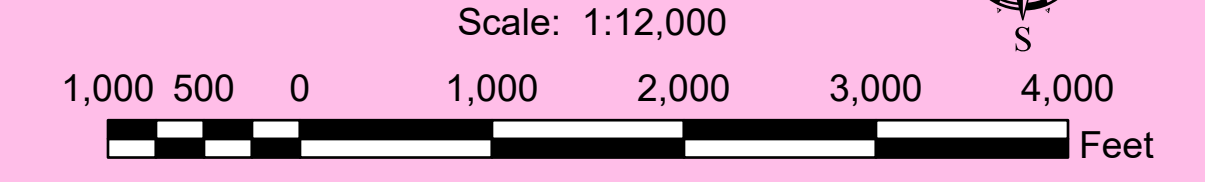
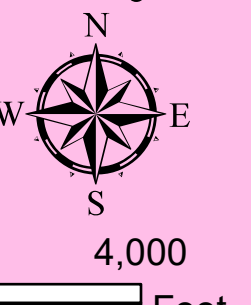

PROPOSED ADDITIONAL 10 AC FT

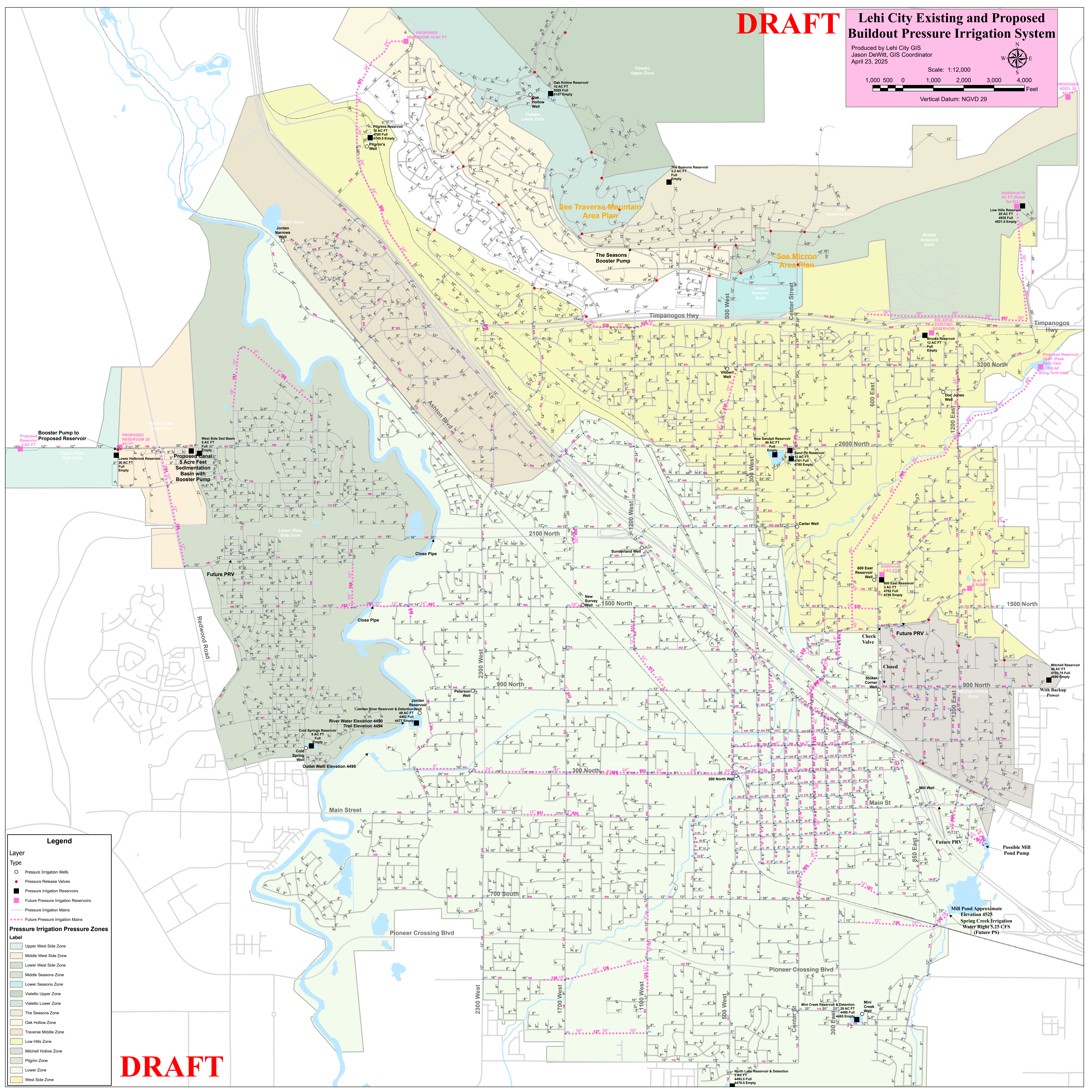

Booster Pump to Proposed Reservoir

Proposed Reservoir 5 AC FT

Proposed Canal: 5 Acre Feet Sedimentation Basin with Booster Pump

Proposed Reservoir 30 AC FT

Proposed Reservoir 10 AC FT

Proposed Reservoir 12 AC FT

Proposed Reservoir 20 AC FT

Proposed Reservoir 28 AC FT

Proposed Reservoir 30 AC FT

Proposed Reservoir 32 AC FT

Proposed Reservoir 34 AC FT

Proposed Reservoir 36 AC FT

Proposed Reservoir 38 AC FT

Proposed Reservoir 40 AC FT

Proposed Reservoir 42 AC FT

Proposed Reservoir 44 AC FT

Proposed Reservoir 46 AC FT

Proposed Reservoir 48 AC FT

Proposed Reservoir 50 AC FT

Proposed Reservoir 52 AC FT

Proposed Reservoir 54 AC FT

Proposed Reservoir 56 AC FT

Proposed Reservoir 58 AC FT

Proposed Reservoir 60 AC FT

- ### Legend
- Layer Type
- Pressure Irrigation Wells
 - Pressure Release Valves
 - Pressure Irrigation Reservoirs
 - Future Pressure Irrigation Reservoirs
 - Pressure Irrigation Mains
 - Future Pressure Irrigation Mains
- ### Pressure Irrigation Pressure Zones
- Label
- Upper West Side Zone
 - Middle West Side Zone
 - Lower West Side Zone
 - Middle Seasons Zone
 - Lower Seasons Zone
 - Vialetto Upper Zone
 - Vialetto Lower Zone
 - The Seasons Zone
 - Oak Hollow Zone
 - Traverse Middle Zone
 - Low Hills Zone
 - Mitchell Hollow Zone
 - Pilgrim Zone
 - Lower Zone
 - West Side Zone

DRAFT

North Lake Reservoir & Detention Well 3 AC FT 4485 Full 4479.5 Empty

Mini Creek Reservoir & Detention Well 3 AC FT 4488 Full 4485 Empty

Mini Creek Reservoir & Detention Well 3 AC FT 4488 Full 4485 Empty

Mitchell Reservoir 40 AC FT 4782.75 Full 4690 Empty With Backup Power